

# 1" Non-Metallic Shock Blocker



1" Shock Blocker

## Specifications

Pulsation Dampener Type	Non-Metallic / Automatic
Material	See model description chart
Weight	Polypropylene 8.4 lbs (3.8 kgs) Conductive Acetal 8.6 lbs (3.9 kgs) Pure Kynar (PVDF) 9.0 lbs (4.1 kgs)
Material Inlet/Outlets	SB10X-AXX 1" - NPTF (Female) (Both are available) SB10X-BXX - 1" BSP (Female)
Air Inlet	Air Tamer is 3/8" NPTF (Male) (Standard)
Maximum Air Inlet Pressure	100 PSIG (6.9 bar)
Maximum Material Inlet Pressure	100 PSIG (6.9 bar)
Maximum Temperature Limits	Polypropylene 35° F - 100° F (+1.6° C - 37.7° C) Conductive Acetal 10° F - 180° F (-12° C - 82° C) Pure Kynar 10° F - 200° F (-12° C - 93° C)
Maximum Fluid Volume	57 In. <sup>3</sup> (931)

## Dimensions

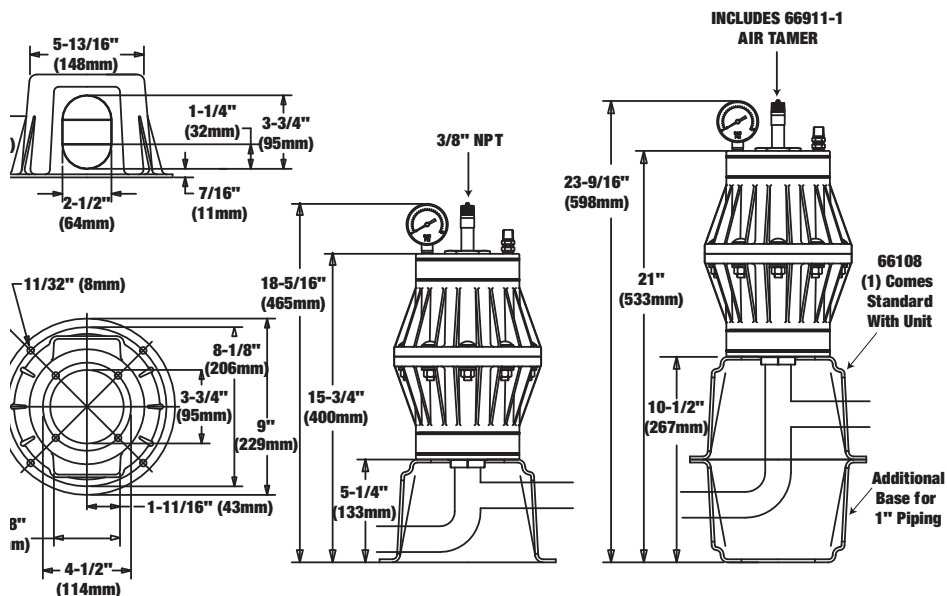

## Ordering

Position	1	2	3		4	5	6		7
Example:	SB	10	X	-	X	X	X	-	X

Position 1 Model Series	Position 2 Size	Position 3 Air Body	Position 4 Thread	Position 5 Fluid Construction	Position 6 Hardware	Position 7 Diaphragm
SB- Shock Blocker	10 - 1"	P - Polypropylene K - Pure Kynar (PVDF) D - Conductive Acetal	A - NPT B - BSP	P - Polypropylene K - Pure Kynar (PVDF) D - Conductive Acetal	S - Stainless (304)	A - Santoprene C - Hytrel T - PTFE U - Urethane

# Design Features

2" & 3" METALLIC SHOCK BLOCKER

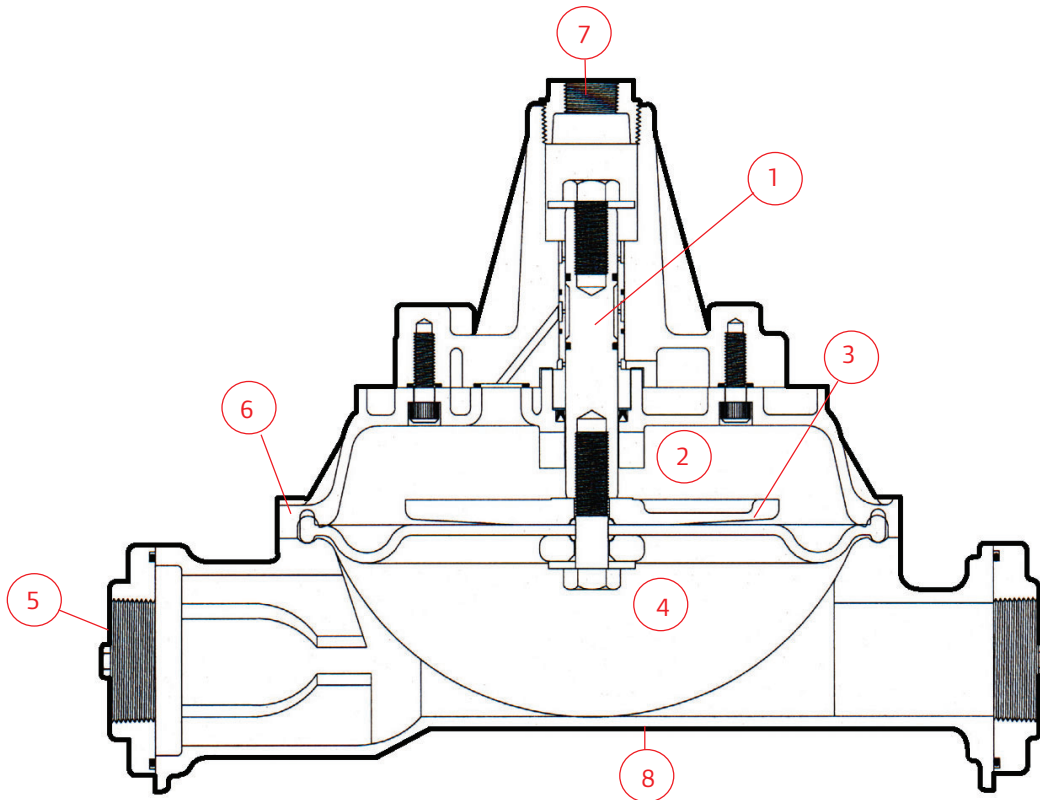

- ① **Auto-Adjust Valve** Similar to ARO's patented Air Tamer design; automatically adjusts to fluid pressure to reduce pulsation
- ② **Air Chamber** Large air chamber offers air support to the diaphragm during the pulsation process and smoothing of fluid pressure
- ③ **Diaphragm** flexes as fluid pulses from the pump
- ④ **Large Fluid Section** offers sensitivity for 2" and 3" diaphragm pump fluid volumes
- ⑤ **Fluid Inlet/Outlet Ports**  
NPTF & BSPP internal pipe threads for 2" & 3",  
ANSI/DIN Option for 2"
- ⑥ **Bolted Fasteners**  
For leak-free integrity, similar design and characteristics which set ARO® Diaphragm Pumps apart from the competition

- ⑦ **Air Inlet** Will accept same air line pressure as diaphragm pump
- ⑧ **Part Interchangeability** Utilize parts from the 2" & 3" diaphragm pump

▶ **Typical Installation** SB20X use with 1-1/2" and 2" Diaphragm Pumps, SB30X use with 3" Metal Diaphragm Pumps

*Proper support of piping and pulsation dampener is required.*

